

Gunton Community Park, Lowestoft, Suffolk

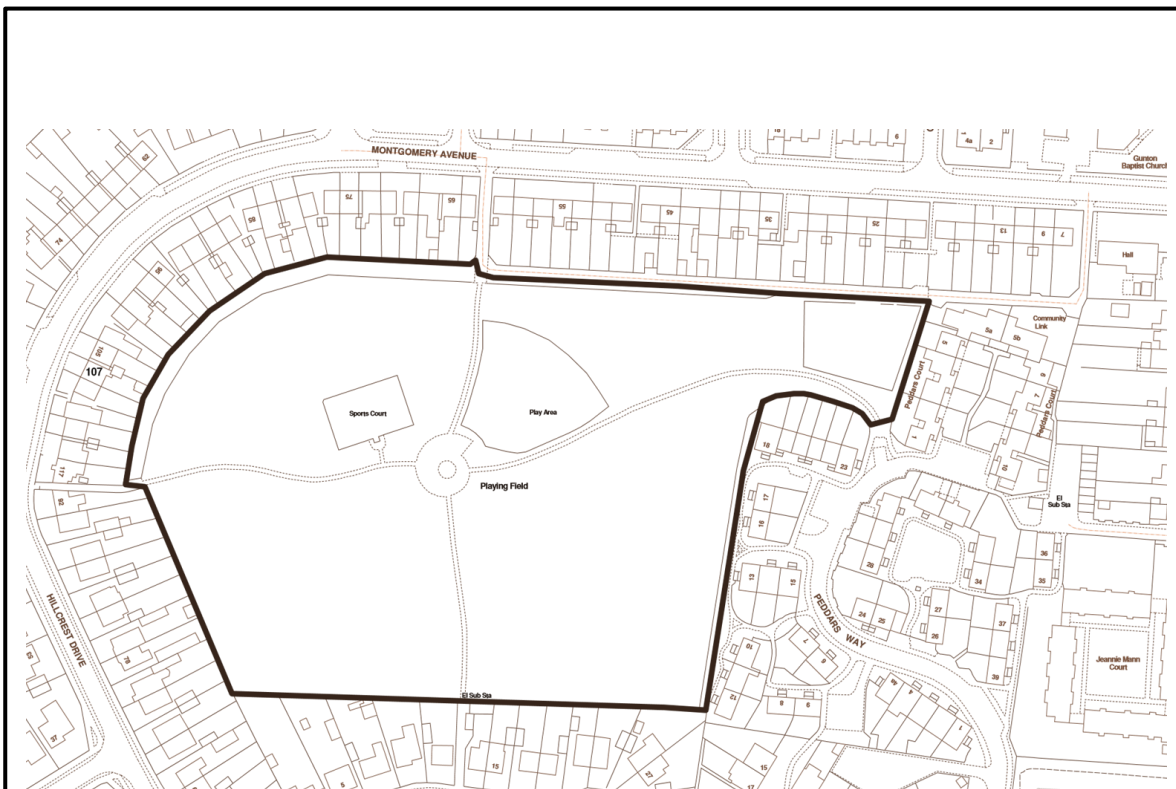

Current Site information

Ward: St Margaret's

Site Reference: SK261132

Area:

Special Status:

Covenants:

Entrances: 5

TPOs:

Services:

Facilities on site:

Access: Vehicular access from Montgomery Avenue, pedestrian access from Hilcrest Drive, Hilcrest Gardens and Peddars Way

Species on Site:

Soil Type:

Issues:

The park is fully enclosed by housing, no visibility from the road which has positive and negative issues

Current main use of site:

The park is a large site which is predominantly used by children and dog walkers. There is a lot of open space but the site does not have the amenities to make it into a destination park, even with the facilities necessary to gain that status the park has no real parking nearby to allow non-locals to access it.

Future planned use of site:

The site has a lot of potential and already has good play equipment and a MUGA. There is also a football pitch which is more for fun and not formal competition as there are no changing facilities or parking. The site contains a wildlife area which has not been cared for but could potentially be improved or relocated to elsewhere on the site. All the paths on site intersect in an area which calls out for a public work of art or specimen/notable tree. In the south eastern corner of the park there are some natural hummocks' and planting which could be emphasised to provide a more natural play area to enhance the other play facilities within the park. The park suffers from a lack of seating, bins and planting which would significantly improve the park for the local residents.

There are three trees coming from the Tree Council plus a cherry tree for the centre of the park with some planting around it.

Key Development Opportunities:

- Definition of areas within the park whilst maintain cohesion across the whole.
- Sports area in south west area
- Community garden/orchard in area towards community centre
- Planting of hedgerow along the rear of the house on Montgomery Avenue between the park and the access way to the houses
- Additional mounds made from "plastic bricks" in the mound area plant with wildflowers to create a natural play area
- Bins
- Bike racks
- Low level lighting
- Benches/picnic benches
- teenage seating
- Drinking water fountain (water supply?)
- additional planting/trees
- toilet/changing room provision but this would need to be assessed.
- CCTV

Resources Required:	Various
Funding Required:	Elements could be funded from the Parks Development Budget as well as the using for seed funding for grants.
Stakeholder Group	No but potential with church, community centre and school.
Friends Group	No
Maintenance	Waveney Norse

Current Benches, Bins and Bike Racks Inventory



Code			
	Item	Quantity	Potential Needed
●	Bin	4	1 for access from community centre and if the community garden is developed then a bins store and green bins.
●	Benches	1	Potential for 2 benches (on the path without backs so that they can be used to sit on and view either way. 4/5 picnic benches near the play area/community garden and mounds and maybe bleacher by the sports area and two teenage pods near the MUGA.
	Bike Rack	0	Potential for three location, near MUGA, community garden and picnic benches and sports area.

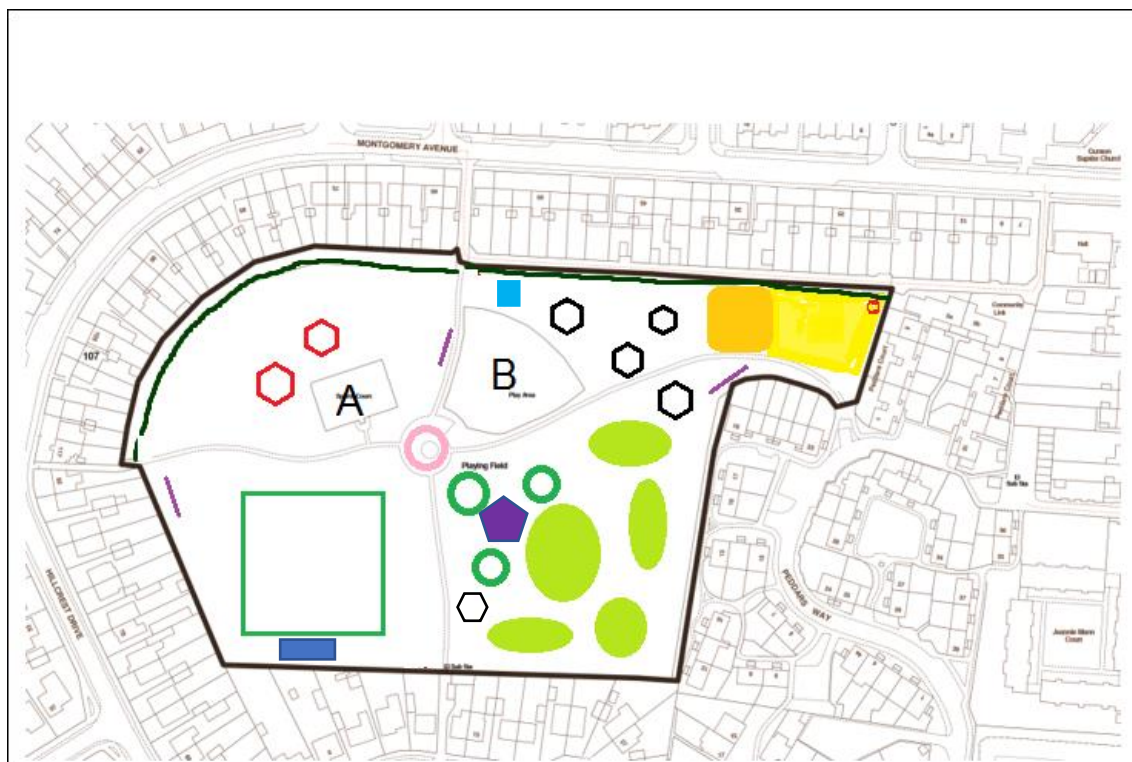

Code

	Wildlife hedge		Picnic Tables
	Football area		Community Garden
A	MUGA/Basketball		Community Orchard
B	Play Area		Plastic Brick mounds
	New Trees		Bike racks
	VJ Cherry Tree		Bleacher
	Story telling chair and stools		Compostable toilet



Tree Council Trees

Morus alba (White circle)

Morus nigra 'Wellington'
(Black circle)

Quercus 'Fastigiata'
(Green circle)

Action Plan Further Information

Planting

Council has already approved 3 x Prunus 'Snow Goose' and 5 x Chaenomeles speciosa 'Moerloosei' for the centre of the park pathways as well as two Mulberries and an evergreen oak for the natural

play area of the park. There are also two plantings of trees already in the park which it would be good to look at continuing those as roughly shown in the above layout. If this is considered a sensible idea then it might be worth progressing them at the same time as the other trees go in as that would reduce the watering costs and also hopefully protect the trees due to the number being planted.

Another planting which could be considered alongside would be that of a mixed native hedge as shown by the dark green line in the park layout plan. This would be a positive environmental addition as it would provide food and cover for wildlife and it would also screen the rear access for the houses on Montgomery Avenue. It would obviously increase maintenance costs in the future but should only need to be cut/laid down once a year. It would be envisioned that the hedge should be no more than 4'-5' tall.

Natural Play Area

The concept here is to enhance the existing mound by adding some more which could be constructed by using plastic bricks (i.e. the plastic stuffed 1l or 2l plastic drink bottles) and then mounding earth and turfing with wild flower turf. The existing mounds could be enhanced by planting wild flower plugs over time. This would provide areas which could be run around, sat on and rolled down. What would also be good to add into this area would be a story telling seat and log style seating in the midst of the three new trees so that in time there will be some natural shade.

Play Equipment and MUGA

These are relatively new and in good condition so no work is required at the moment apart from inspections, general cleaning & maintenance and removal of graffiti.

Community Garden and Orchard

There has been a request for a community garden and with the council's policy it would be beneficial to also have an orchard as there is space. There is a group coming together who would be interested in developing this and that may also lead to the development of a Friends Group for the park which hopefully could include the Ormistan Denes and the Ashley School. The area proposed is the old wild flower area which has fencing already and has not been maintained as a wildflower area for some time. It could be expanded and it has the benefit of being adjacent to a vehicular entrance should compost or other bulky deliveries be required.

Seating

The main seating provision would be to add picnic benches which would be positioned between the play area and the community orchard and in the natural play area. The natural play area could also include the story telling area. There could be a couple of teen pods as shown in the Britten Piece 5YP placed by the MUGA as this seems to be the teen hangout area in the park. As there is a football/grassed play area an appropriate type of seating might be a Bleacher as it would be flexible and provide another area for youngsters to sit. This would provide plenty of seating however there could be the flexibility to add additional benches along the paths surrounding the sports area and if so it would be practical to use benches with no backs so that people could sit on either side to view in different directions.

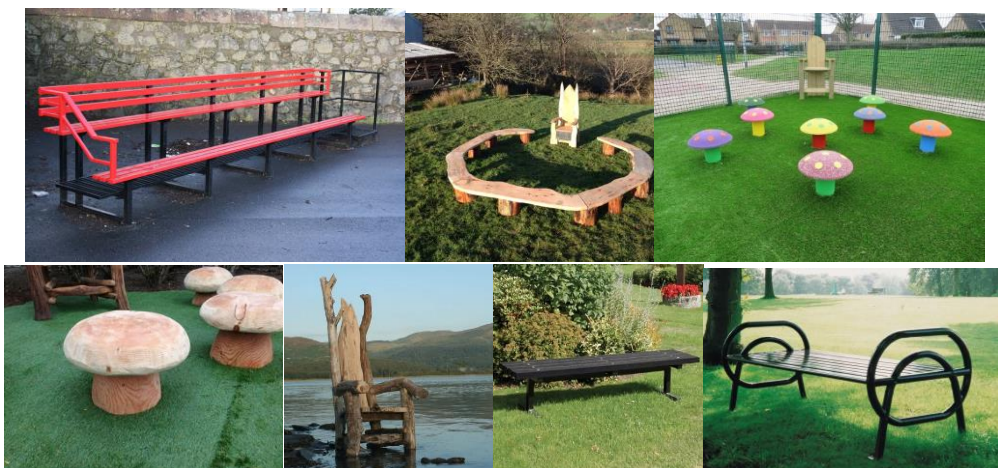

Wildflower area

The area between the hedge and the curved line of trees by the MUGA could be seeded and turned into a wildflower meadow and have dog walking paths cut through it. In time a couple of rowan or hawthorn could be planted to add to the biodiversity and to provide additional interest.

Services

The park already has an electricity supply as demonstrated by the lighting on the bike path and the CCTV. The provision of water on site would be worth considering if a community garden is going to be created. It might be that this is looked at as an initial investigation/action as water on site would be beneficial when we do planting. It would also then allow a drinking fountain to be installed.

An additional benefit to the site would also be a compostable toilet as this would allow gardeners, volunteers and park users to stay at the park for longer.

5 year plan schedule of works				
Year	Item/project	Cost	Existing Budget	To be budget for that year.
2021-22				
2022-23				
2023-24				
2024-25				
2025-26				
Longer Term				