



ESTIMATE

East Point Business Services Ltd
Battery Green Road
Lowestoft
Suffolk, NR32 1DE
Tel: 01502 445445

Date 28/01/2019

Mr Mark Speller
Lowestoft Town Council
Hamilton House
Battery Green Road
Lowestoft
Suffolk
NR32 1DE

Ref : Extra Kitchen Units and Worktop for Breakout kitchen area

Dear Mark

We thank you for your enquiry regarding the above and have pleasure in submitting our estimate to carry out the works which you have requested:

- Supply & Install 1No 300mm light grey oak curved corner wall unit no door and 1No 400mm standard wall unit complete with door and handle both these items to be used as a floor base unit complete with a 150mm plinth to around to bottom of the unit.
- Supply & Install Evora Grey Slate square edged worktop 1600mm long x 450mm deep with one curved end.
- Supply & Install 150mm upstand at the back of the worktop using the existing off cut (as talked about)

Total Cost To Carry Out Works £ 733.00 Plus VAT

We hope this meets with your approval and if you require additional information or have any queries regarding This estimate please contact me at the office

Yours Faithfully

Paul Barker

Office: Hamilton House, Battery Green Road, Lowestoft, NR32 1DE
Phone: 01502 445 445
East Point Business Services LTD
Company Registration No. 9247588 VAT No 218 3515 20

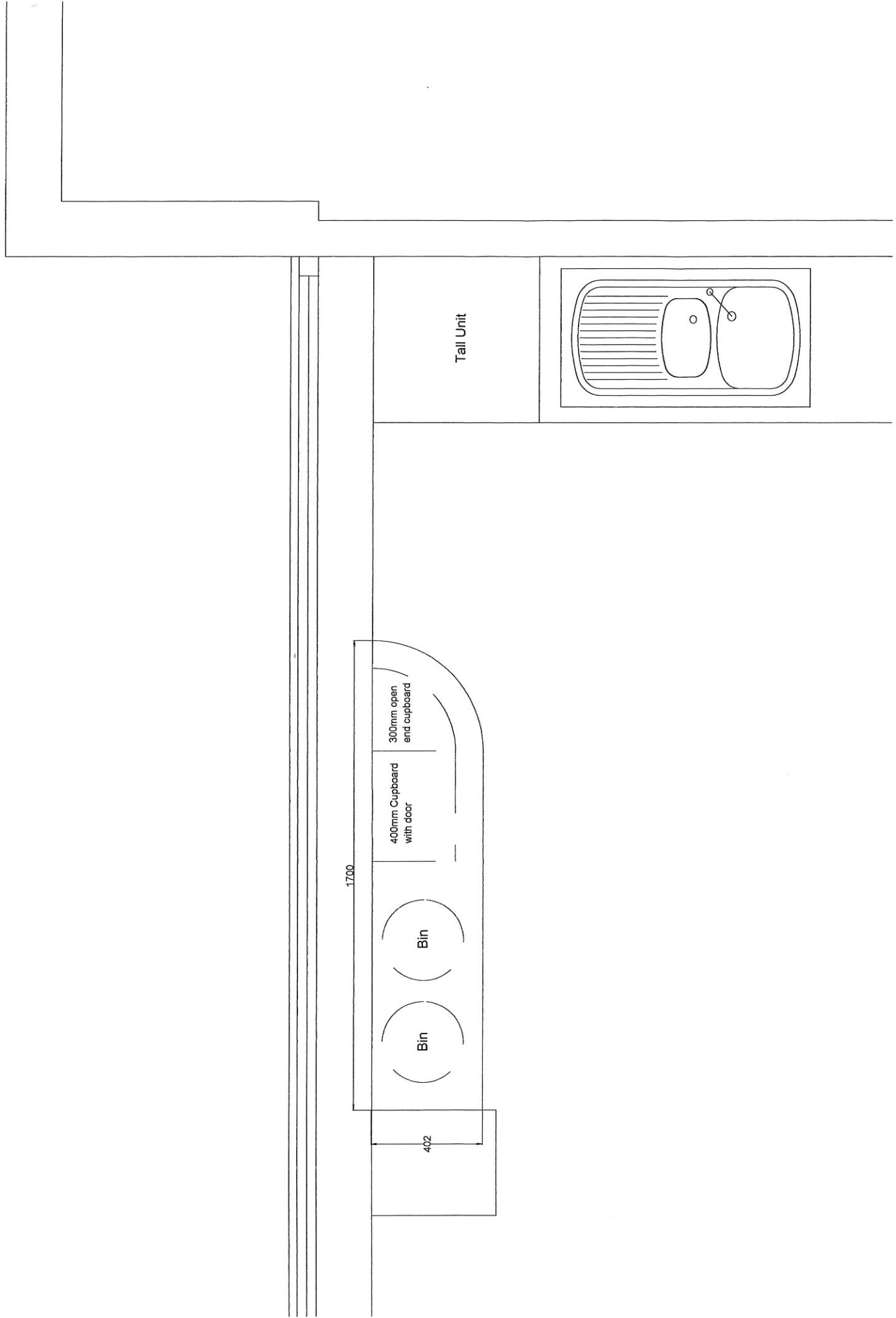

Proposed Kitchen Units and Worktop For Breakout Area